

Connection hoses and cables	
Water hose:	✓
Waste water hose:	✗
Electric cable:	✓

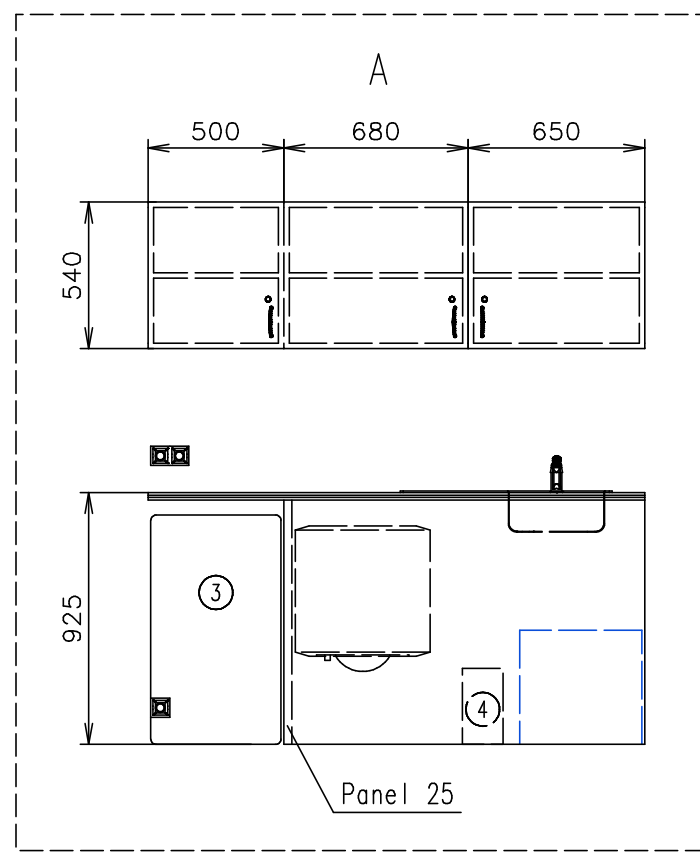
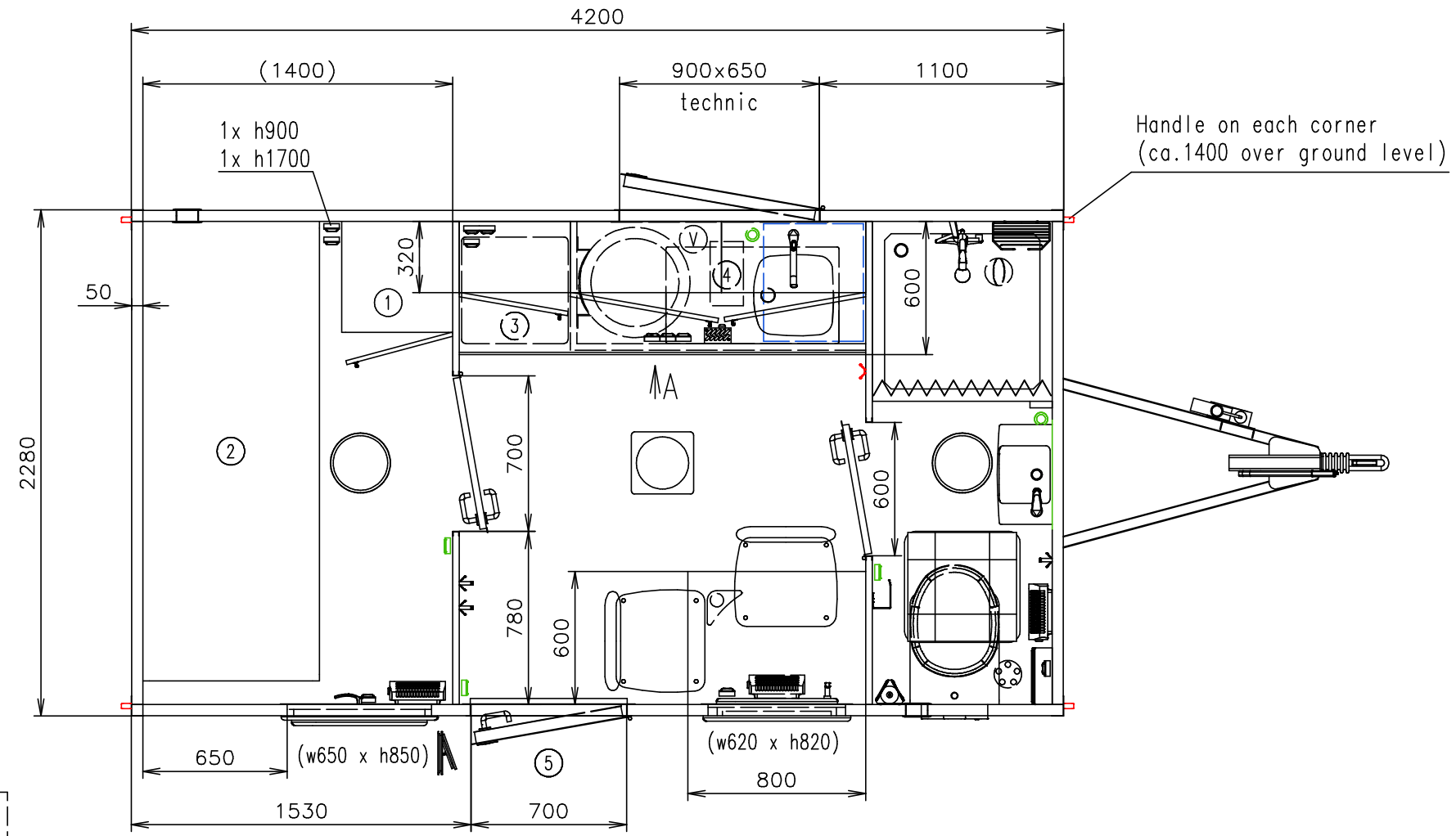

(Cabling and piping is not shown on the 3D views and drawings)

Notes:

Interior height:	2000 mm	Total weight:	1600 kg
Color:	RAL 9010	Tare weight-estimate:	1400 kg
Floor:	PVC Tarkett safetred universal NEBULA	Centre of wheels from rear side:	2120 mm
Date:	4.11.2020	Wheels:	195/50 R13C



Drawing number:  
3691-42-1\_1/2 (Dietrich)

Connection hoses and cables	
Water hose:	✓
Waste water hose:	✗
Electric cable:	✓

- Ⓥ Water connection 3/4" (through the floor)
- Ⓜ Electric connection (on the chassis) (400V-16A)
- Ⓛ Effluent connection ø40 (under floor)
- Ⓜ Power point
- Ⓜ Double power point
- Ⓜ Light switch
- Ⓜ Switch board (under roof)
- Ⓜ LED droplight
- Ⓜ LED droplight
- Ⓜ Heating (200W)
- Ⓜ Heating (500W)
- Ⓜ Shower (800x800) Cola
- Ⓜ Kitchen sink with drainer Alveus Basic 150 + standard water tap
- Ⓜ Wash-basin Kolo (450x250) + standard water tap
- Ⓜ WC Thetford C-224 CW
- Ⓜ Hot water boiler (50 l)
- Ⓜ Water tank (on the floor) (1530 x w450 x h420 = 80l)
- Ⓜ Floor drain hole
- Ⓜ Ventilation ø120
- Ⓜ Window opening inside (870 over floor) + inside blinders (white)
- Ⓜ Window opening out (870 over floor) + inside blinders (white)
- Ⓜ Roof window Dometic (400x400)
- Ⓜ Chair
- Ⓜ Desk permanent fixed (800x600)
- Ⓜ Brush toilet
- Ⓜ Toilet paper holder
- Ⓜ Shelf steel
- Ⓜ Shower curtain
- Ⓜ Clothes hanger
- Ⓜ Clothes hanger
- Ⓜ Mirror (500x500)
- ① Cupboard (500 x 500 x 1850) (4x shelf)
- ② Bunk bed (2070 x 795)
- ③ Fridge
- ④ Water pump Grundfos hydrojet JP5 (230V)
- ⑤ Standard free standing stairs

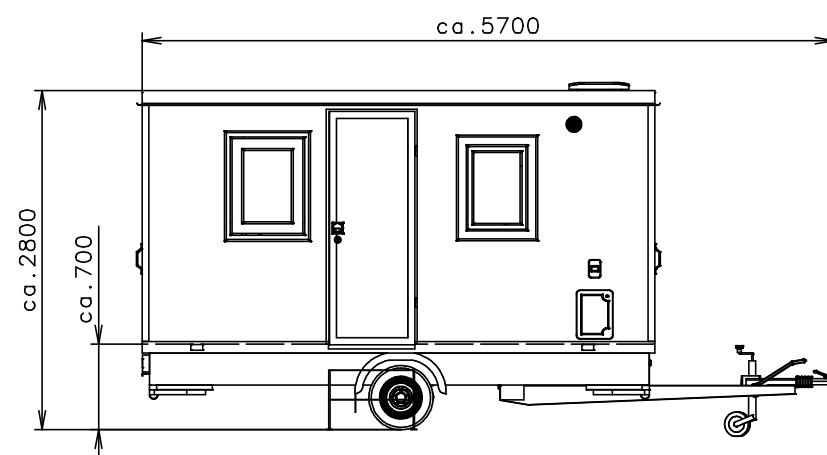

(Cabling and piping is not shown on the 3D views and drawings)

Notes:

Interior height:	2000 mm	Total weight:	1600 kg
Color:	RAL 9010	Tare weight-estimate:	1400 kg
Floor:	PVC Tarkett safetred universal NEBULA	Centre of wheels from rear side:	2120 mm
Date:	4.11.2020	Wheels:	195/50 R13C

**EUROWAGON**

Drawing number:  
3691-42-1\_2/2 (Dietrich)